



**1 Jutland House Dedworth Road, Windsor, SL4 5BE**  
**£225,000**

 **HORLER**

## 1 Jutland House Dedworth Road, Windsor, SL4 5BE

A well-presented ground floor apartment located in a quiet cul-de-sac off Dedworth Road, Windsor. The property offers a spacious reception room, one generous double bedroom, a modern fitted kitchen, and a stylish bathroom. Residents also benefit from communal gardens and convenient access to local amenities, making it an ideal home for individuals, couples, or investors seeking comfortable living in a desirable location.



### **Property Summary**

Located in a cul-de-sac off the Dedworth Road in the charming town of Windsor, this delightful ground floor apartment offers a perfect blend of comfort and modern living. The property features a spacious reception room that welcomes you with warmth and light, making it an ideal space for relaxation or entertaining guests.

The apartment boasts one generously sized double bedroom, providing a peaceful retreat for rest and rejuvenation. The modern fitted kitchen is equipped with contemporary appliances, ensuring that cooking is a pleasure rather than a chore. The stylish bathroom complements the apartment's modern aesthetic, offering a serene space for your daily routines.

Residents will also appreciate the communal gardens, which provide a lovely outdoor area to enjoy fresh air and greenery. This apartment is perfect for individuals or couples seeking a convenient and comfortable home in a sought-after location.

With its proximity to local amenities and the picturesque surroundings of Windsor, this property presents an excellent opportunity for those looking to embrace a vibrant lifestyle. Whether you are a first-time buyer or seeking a rental investment, this charming flat is sure to impress.

### **General Information**

Lease remaining: 990

Service charge: Approx. £700.00 per year

### **Legal Note**

\*\*\*Although these particulars are thought to be materially correct their accuracy cannot be guaranteed and they do not form part of any contract\*\*\*





# Jutland House SL4

Approximate Gross Internal Floor Area = 47.0 sq m / 506 sq ft

Store Area = 1.6 sq m / 18 sq ft

Total Area = 48.6 sq m / 524 sq ft

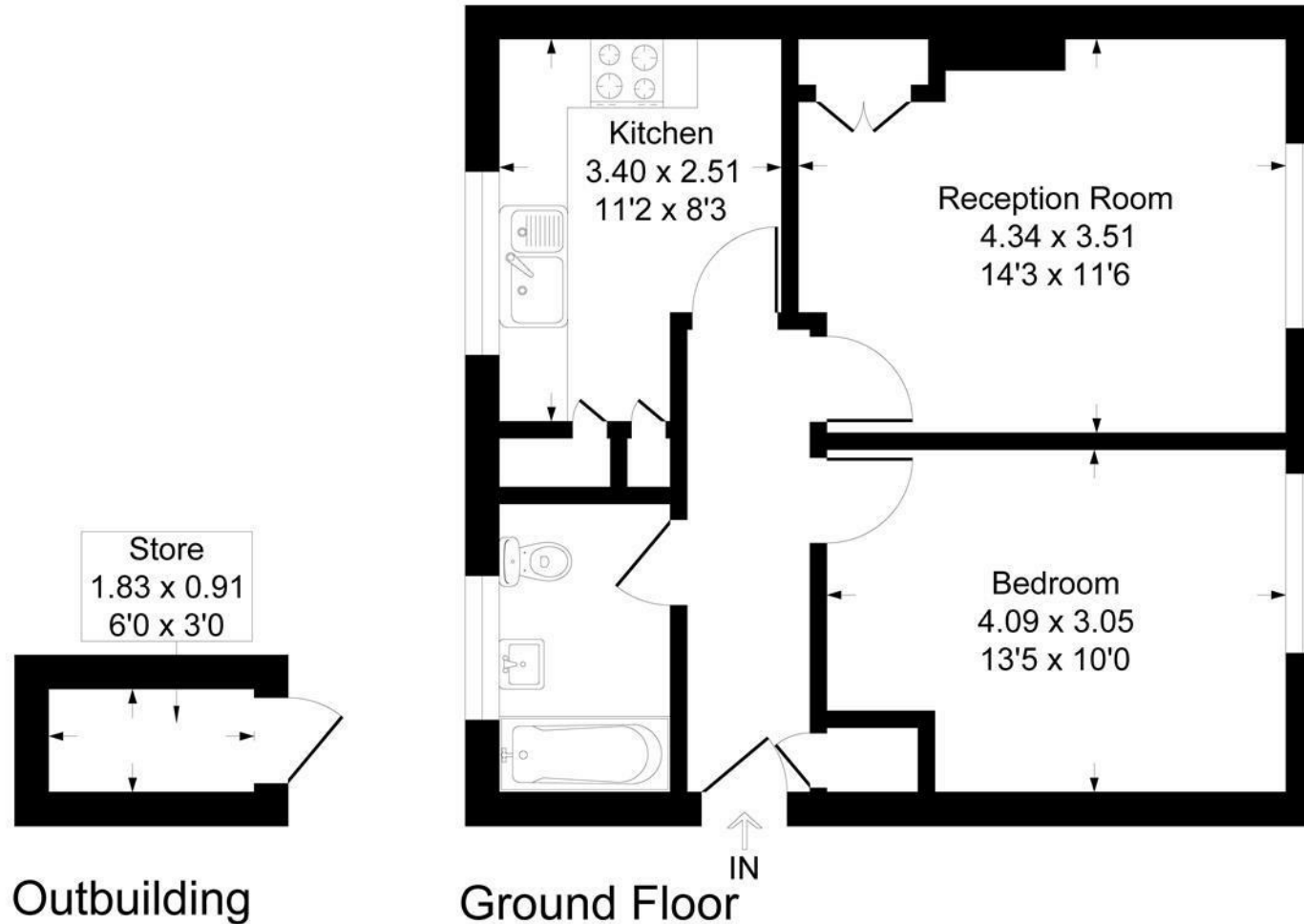

Illustration for identification purposes only, measurements are approximate, not to scale.

Produced By Esjay Property Marketing